

Valid for heat exchanger 10016227

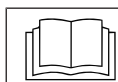

Read the installation instructions for the units and observe the safety information.

The target group for this installation manual is trained qualified personnel entrusted with the technical functioning and operation of the unit.

Safety

Organizational measures

Risk of property damage and personal injury from lack of organizational measures

- Use equipment and protective gear suitable for the activity.

Danger of electric shock from live components.

- Prior to working on the electrical system, switch off the unit, disconnect the electrical system from the mains and prevent power from being switched on again. Check to ensure the system is dead.
- Use only insulated tools.

Risk of explosion and fire from improper connection

- Prior to working on the gas system, switch off the unit, close the gas supply from the gas system and secure it against being reopened. When bleeding air or degassing, ensure that the air and gas are discharged to the outside in a technically correct manner and without creating a risk.

Preparations

- Remove the left side wall.
- Dismount air diverter.

Ignition electronics

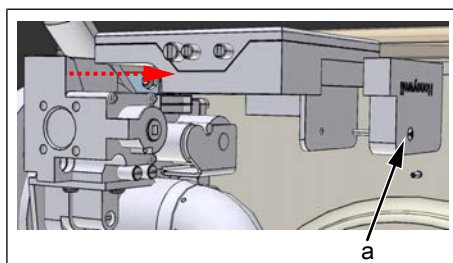

Image: Fastening the ignition electrode

a Screw

Gas magnetic valve

Overview

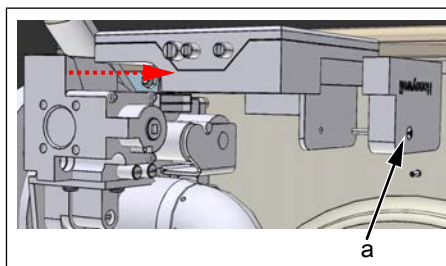

Image: Fastening the ignition electrode

a Screw

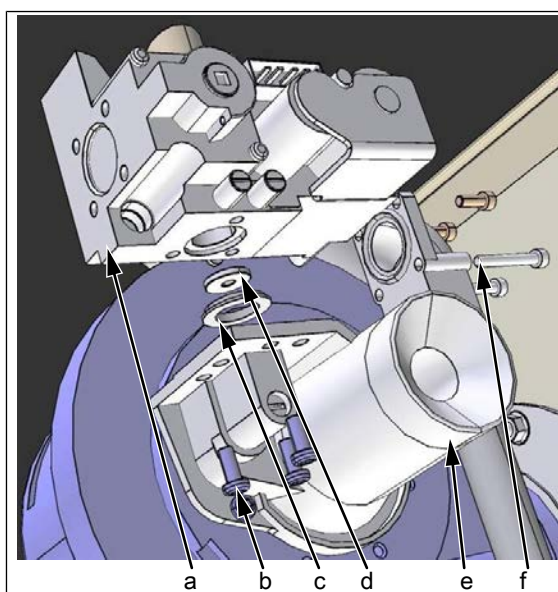

Image: Fastening the gas solenoid valve

- | | |
|----------------------|---|
| a Gas magnetic valve | b Screws for fastening the gas solenoid valve |
| c Seal | d Gas orifice |
| e Venturi pipe | f Screws for gas hose (supply line) |

Disassembly

Ignition electronics

- Remove screw.
- Remove the cover.
- Remove electrical connections.
- Remove ignition electronics from the solenoid valve.

Magnetic valve

- Remove supply pipe from Venturi pipe

Gas heat exchanger

- Remove three fastening screws from the Venturi pipe.
- Remove magnetic valve.
- Detach gas hose.
- Remove gas orifice and seal.

Gas fan

Overview

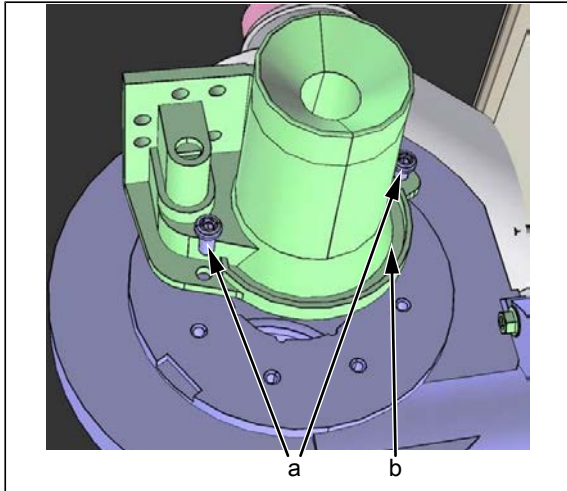

Image: Fastening the Venturi pipe

a Screw

b Venturi pipe

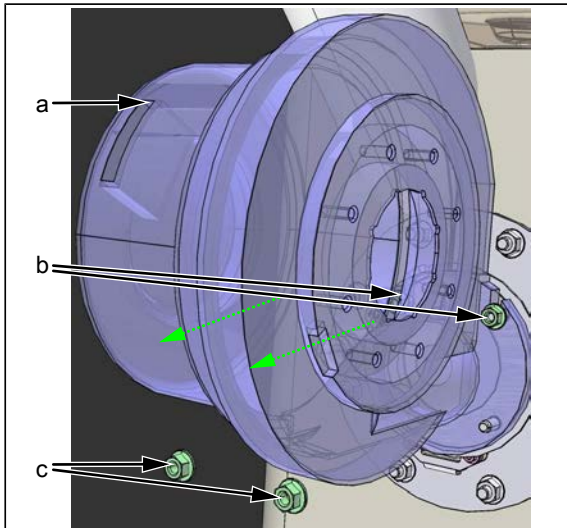

Image: Fastening the gas fan

a Gas fan

b Top nut

c Bottom nut

Disassembly

- Loosen screws and remove the Venturi pipe.
- Unplug connector from gas fan.
- Loosen top nuts on gas fan (do not remove).
- Remove bottom nuts from gas fan.
- Remove gas fan.

Gas burner

Overview

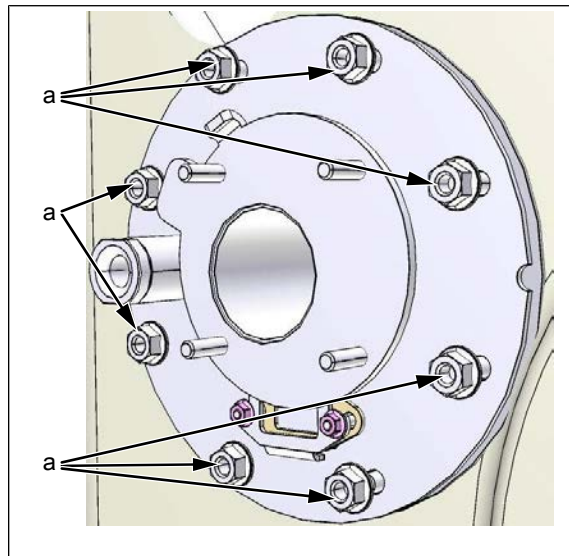

Image: Fastening the burner

a Nut

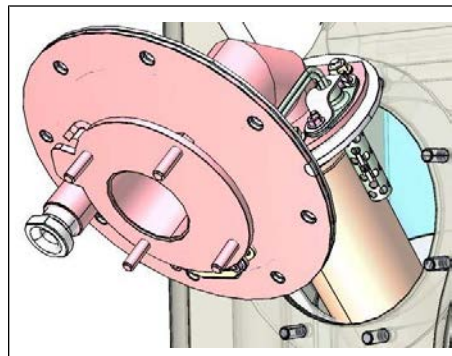

Image: Removing the burner

Disassembly

- Detach electrical connections on the electrodes.
- Dismount nuts.
- Remove gas burner.

Heat exchanger

Dismantle exhaust pipe

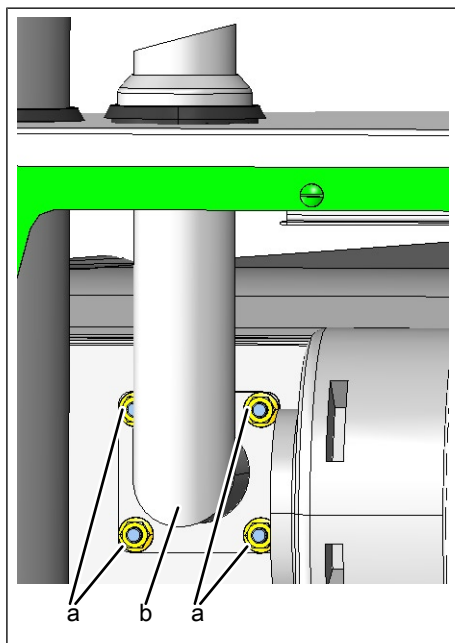

a Nuts

b Exhaust pipe with insulation

- Remove insulation from the exhaust pipe.
- Dismantle nuts and remove exhaust pipe.

Dismantle water supply pipe

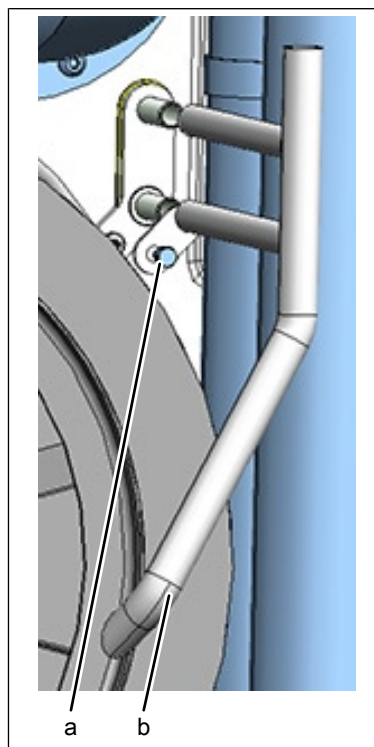

a Screw

b Water supply pipe

Image: Water supply pipe using the example of unit size 10

- Dismount screw.
- Pull off the water supply pipe.

Dismantle heat exchanger

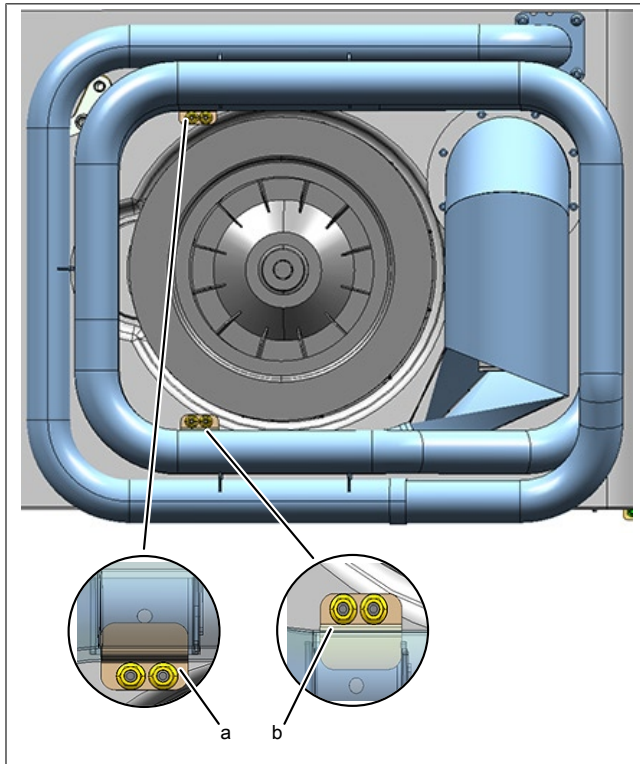

Image: Gas heat exchanger

a Holder top

b Holder below

- Dismount nuts.
- Remove both retaining plates.
- Dispose of retaining plates. The plates supplied with the heat exchanger must be used for installation!
- Remove heat exchanger.
- Dispose of seals. Remove any residue from the seal on the cooking chamber.

Assembly

⚠ WARNING

Risk of asphyxiation and explosion from damaged seals

- Check seals for damage.
- Replace damaged seals.

⚠ WARNING

Risk of explosion and fire from leaking, gas-conducting parts

- Heed tightening torques for the screw connections.
- Check the gas connection line and all gas-conducting parts for leaks at the operating pressure.

NOTICE

Risk of poisoning from exhaust gases

- CO₂ calibration required.
- ⇒ Perform CO₂ calibration according to installation instructions/service instructions.

Heat exchanger and exhaust pipe

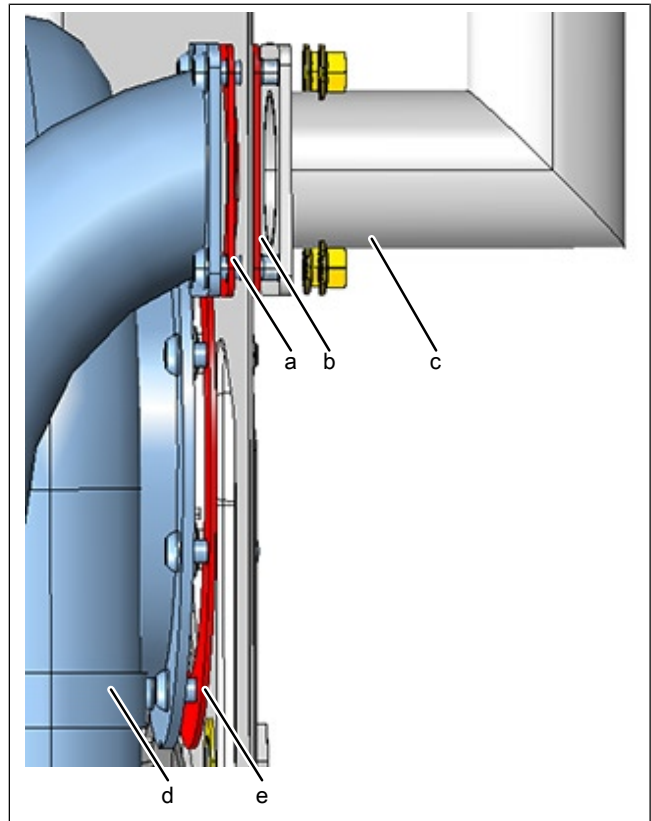

Image: Overview seals

a Seal 211144

b Seal 211144

c Exhaust gas duct

d Gas heat exchanger

e Seal 211143

- Assemble the heat exchanger in reverse order. Use the enclosed seals for this purpose.
- Install the enclosed retaining plates. The torque for the nuts is 8 Nm.

- Install exhaust pipe and insulation. The torque for the nuts is 8 Nm.
- Mount the water supply pipe.

Remaining components

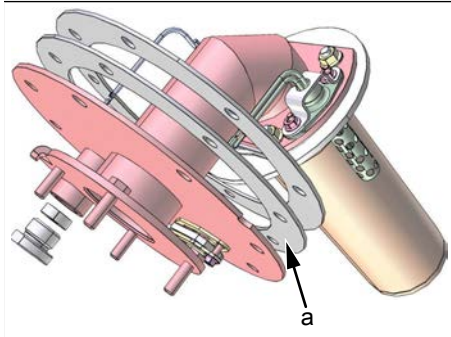

Image: Seal gas burner

a Seal 211143

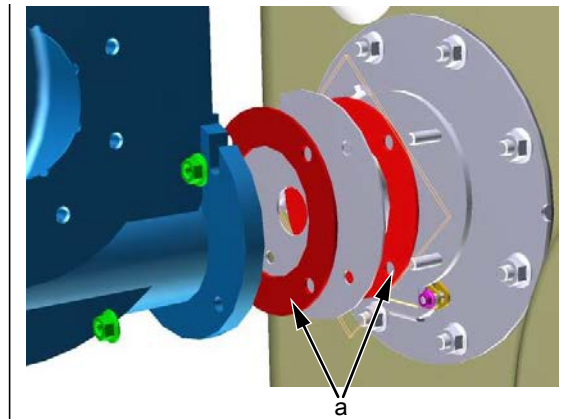

Image: Gas fan seals

a Seal 211142

- Reassembly is carried out in reverse order. The seals on the burner must be replaced.
 - ↳ Install screws for the burner using anti-seize paste and tighten to a torque of 6 Nm.
 - ↳ Install screws for the gas fan using anti-seize paste and tighten to a torque of 5 Nm.
 - ↳ Install screws for the Venturi pipe using anti-seize paste and tighten to a torque of 3 Nm.
 - ↳ Install screws for the gas hose using threadlocker (e.g. Loctite 586) and tighten to a torque of 3 Nm.