

## Valid for spring 10030071



**Read the installation instructions for the units and observe the safety information.**

The target group for this installation manual is trained qualified personnel entrusted with the technical functioning and operation of the unit.

## Safety instructions

### Organizational measures

#### Risk of property damage and personal injury from lack of organizational measures

- Use equipment and protective gear suitable for the activity.

#### Danger of electric shock from live components.

- Prior to working on the electrical system, switch off the unit, disconnect the electrical system from the mains and prevent power from being switched on again. Check to ensure the system is dead.
- Use only insulated tools.

## Remove latching lugs

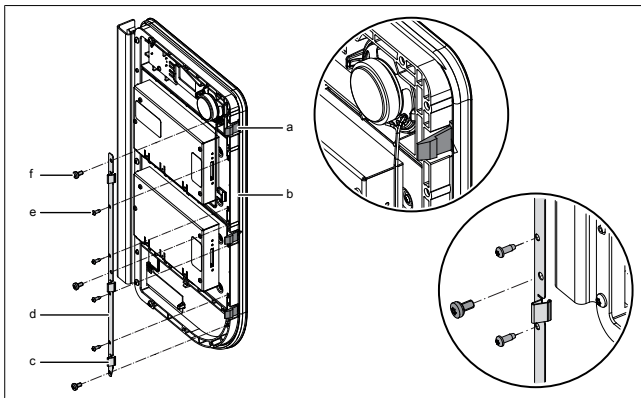

Image: Switch panel with spring

- |                           |                         |
|---------------------------|-------------------------|
| a Latching lugs (old)     | d Spring                |
| b Operating panel         | e Screw (control panel) |
| c Latching lugs at spring | f Screw (spring)        |

1. Open the control panel.

2. Remove old latching lugs.  
↳ Dispose of latching lugs properly.
3. Loosen the screws on the control panel.  
↳ Store screws carefully for assembly.

## Install spring

1. Position spring and align via holes.  
↳ Latching lugs of spring should be just above the stop of the combisteamer.
2. Carefully and lightly screw in the screws on the spring.  
↳ Make sure that the spring is not distorted.
3. Screw in the screws on the control panel.

## Adjust spring

### INFORMATION

Be careful when adjusting the latching lugs. Do not stress the latching lugs by bending them several times.

### INFORMATION

Use a suitable tool to bend the latching lugs together.

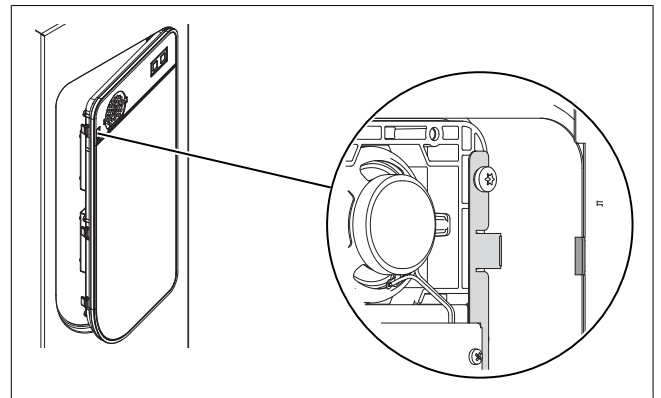

Image: Adjusting the latching lug

- Carefully bend the latching lugs together slightly.  
↳ The control panel locks more easily in the combisteamer.

### Readjusting the stop of the combisteamer

---

#### INFORMATION

Be careful when adjusting the stop on the combisteamer.

---

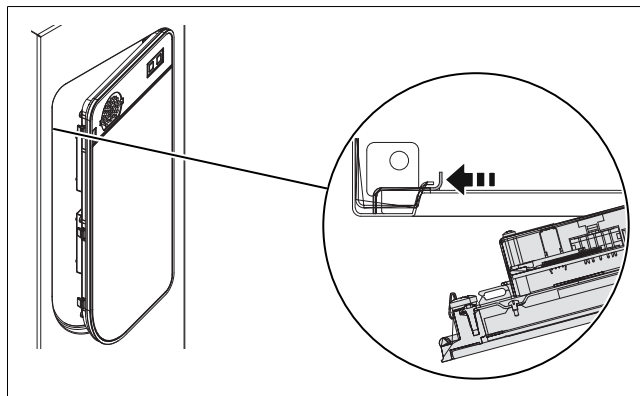

Image: Adjusting the stop on the combisteamer

- Carefully bend the counterparts of the latching lugs a little inwards (see arrow).
- ↳ Unlocking the control panel is smoother.