

Valid for metal spring detents 10034594



Read the installation instructions for the units and observe the safety information.

The target group for this installation manual is trained qualified personnel entrusted with the technical functioning and operation of the unit.

Tools to be kept in stock

- Screwdriver TX10
- Screwdriver TX15
- Suitable M3 slotted screwdriver
- Socket wrench 5.5

Safety instructions

Organizational measures

Risk of property damage and personal injury from lack of organizational measures

- Use equipment and protective gear suitable for the activity.

Danger of electric shock from live components.

- Prior to working on the electrical system, switch off the unit, disconnect the electrical system from the mains and prevent power from being switched on again. Check to ensure the system is dead.
- Use only insulated tools.

Preparatory work

- Open the control panel.
- Remove existing detents on the operating panel.

Mount metal spring

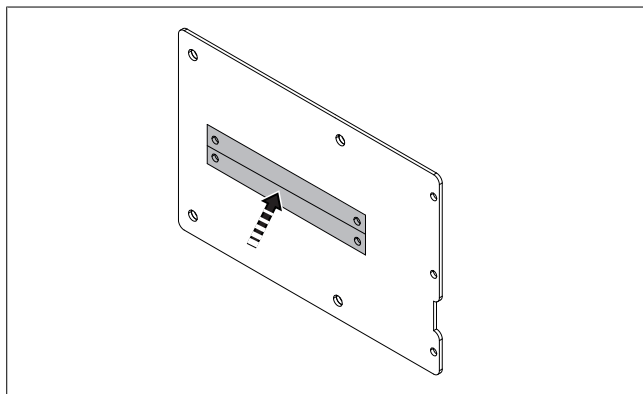

- Break out sheet metal strip from plate.

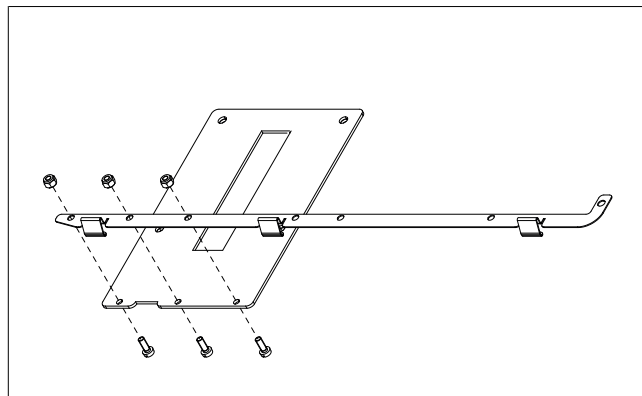

- Place plate on metal spring and connect with 3 bolts and nuts.

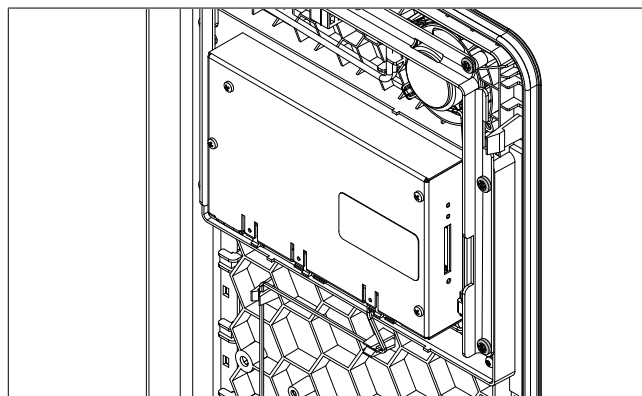

- Loosen the screws on the control panel.
- Place the plate with metal spring and fasten the metal spring to the control panel with existing screws.

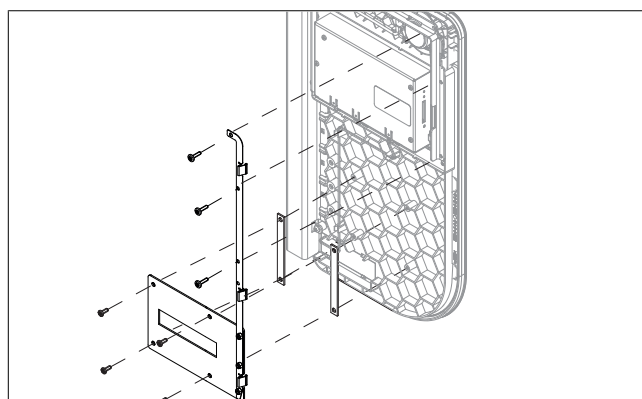

- Place the sheet metal strip and screw the plate tight.

Concluding work

INFORMATION

Be careful when adjusting the latching lugs.

Do not stress the latching lugs by bending them several times.

INFORMATION

Use a suitable tool to bend the latching lugs together.

- Carefully bend the latching lugs together slightly.
 - ↳ The control panel snaps into the combi steamer more easily.

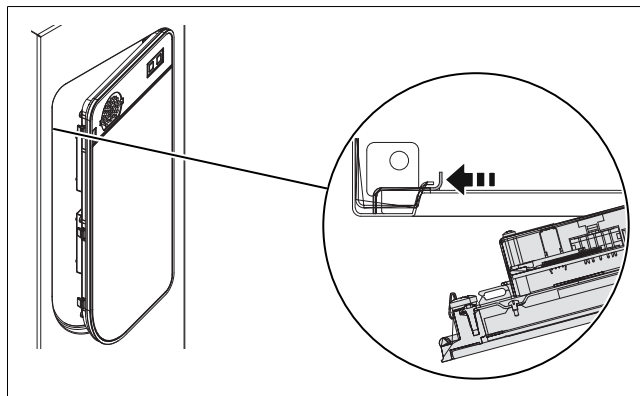

- Carefully bend the counterparts of the latching lugs on the combi steamer inward a little.
 - ↳ Unlocking the control panel is smoother.