

Valid for fan wheel 10029463



Read the installation instructions for the units and observe the safety information.

The target group for this installation manual is trained qualified personnel entrusted with the technical functioning and operation of the unit.

Safety instructions

Organizational measures

Risk of property damage and personal injury from lack of organizational measures

- Use equipment and protective gear suitable for the activity.

Danger of electric shock from live components.

- Prior to working on the electrical system, switch off the unit, disconnect the electrical system from the mains and prevent power from being switched on again. Check to ensure the system is dead.
- Use only insulated tools.

Special tool required

- Fan wheel puller 10016069

Remove suspension racks

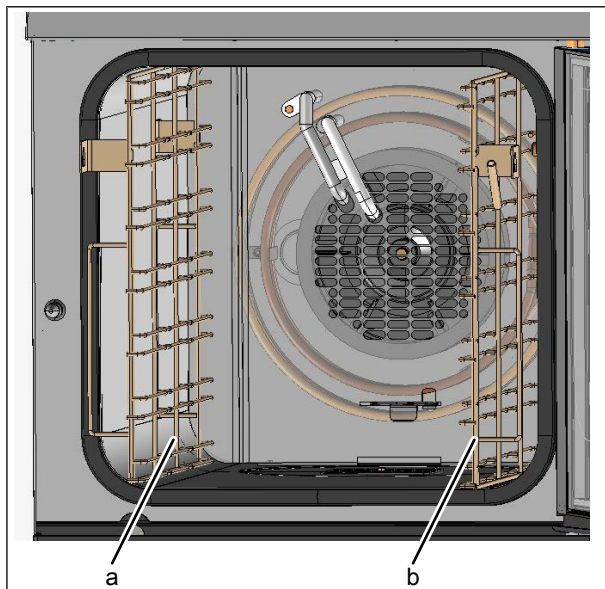

a Suspension frame left b Suspension rack right

- Open the cooking chamber door
- Remove the two suspension racks.

Removing the air diverter

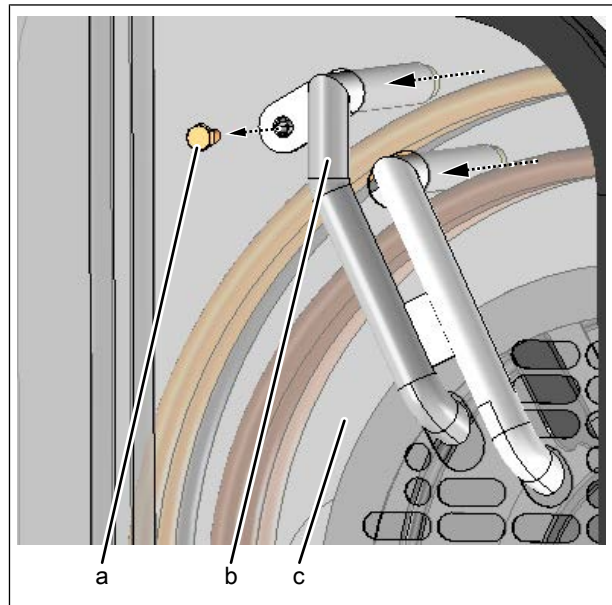

a Hex head screw b Water inlet pipe
c Air diverter

- Dismantle hexagon head screw
- Pull off water inlet pipe
- Remove air baffle

Remove fan wheel

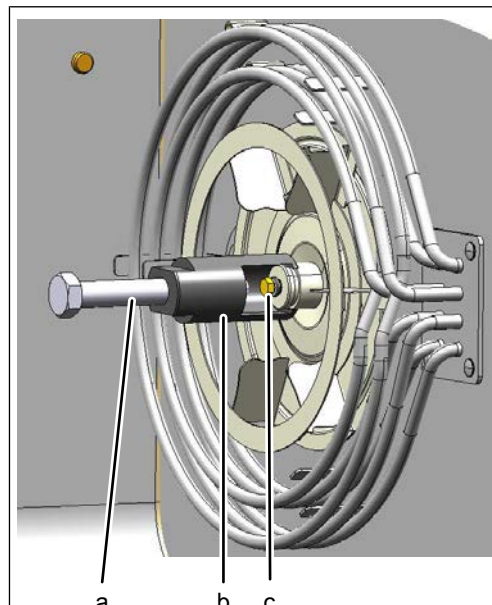

Image: Puller in position

a Fan wheel b Fan wheel puller
c Screw fan wheel

10000016181AM0AE-

Replacement of the fan wheel

- Loosen the screw of the fan wheel. Hold the fan wheel while doing so.
 - ↳ Do not damage the fan wheel.
- Move the fan wheel puller into position.

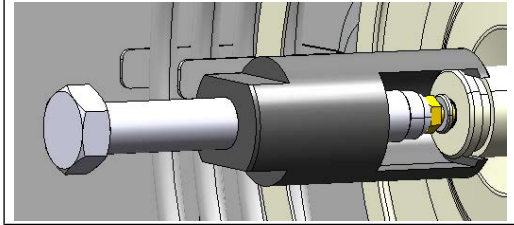

Image: Fix fan wheel puller

- Fix the fan wheel puller.

- Continue to screw in the screw on the puller with the appropriate tool until the fan wheel comes off the shaft. Hold the fan wheel while doing so.
 - ↳ Do not damage the fan wheel.

Mount fan wheel

- Slide the fan wheel onto the shaft of the motor.
- Tighten nuts. Hold the fan wheel carefully while doing so. The fan wheel must not be damaged or bent.

INFORMATION

The torque should be 10 Nm.

Assemble remaining components

The remaining parts are assembled in the reverse order.