

Valid for locking washer 10028883 and shaft seal 10029110



Read the installation instructions for the units and observe the safety information.

The target group for this installation manual is trained qualified personnel entrusted with the technical functioning and operation of the unit.

Safety instructions

Organizational measures

Risk of property damage and personal injury from lack of organizational measures

- Use equipment and protective gear suitable for the activity.

Required tools

- Fan wheel puller 10016069

Overview of locking washer and shaft seal

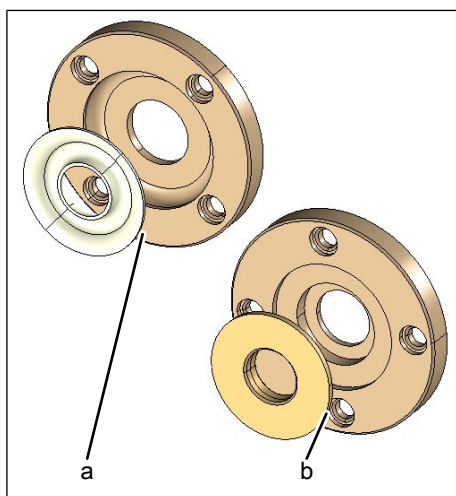

a Previous shaft seal 10018526

b Actual shaft seal 10029110

Remove suspension racks

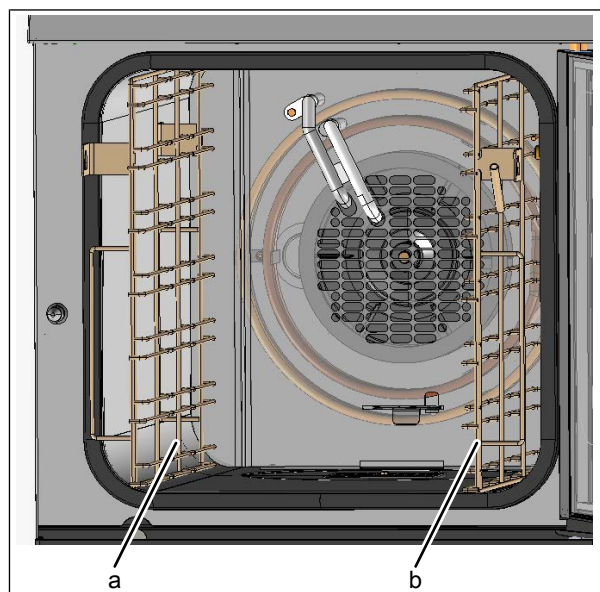

a Suspension frame left b Suspension rack right

- Open the cooking chamber door
- Remove the two suspension racks.

Removing the air diverter

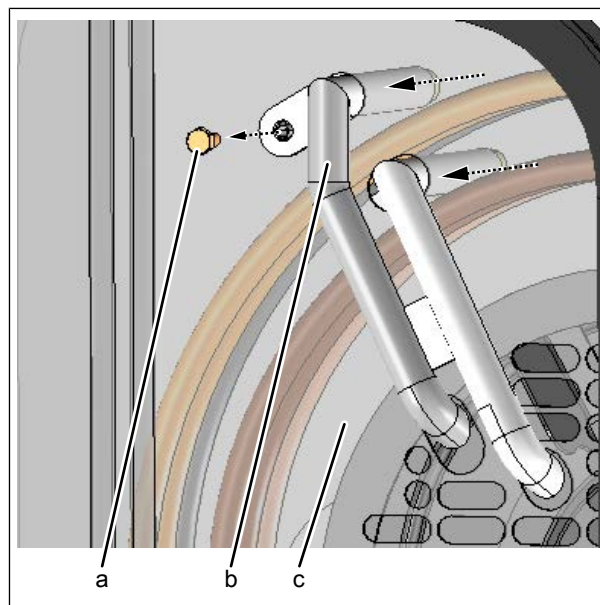

a Hex head screw b Water inlet pipe
c Air diverter

- Dismantle hexagon head screw
- Pull off water inlet pipe
- Remove air baffle

Remove fan wheel

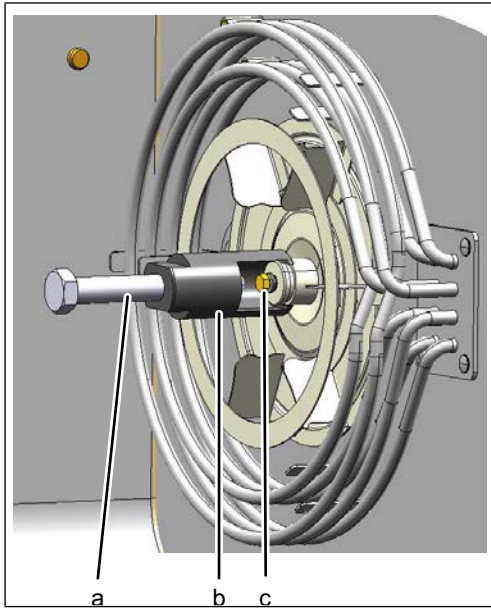

Image: Puller in position

- a Fan wheel
- b Fan wheel puller
- c Screw fan wheel

→ Loosen the screw of the fan wheel. Hold the fan wheel while doing so.

↳ Do not damage the fan wheel.

→ Move the fan wheel puller into position.

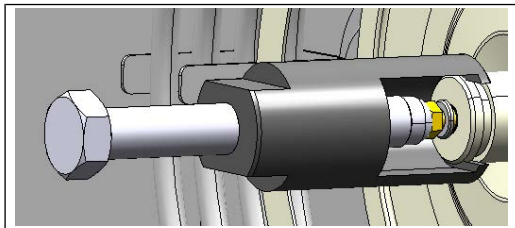

Image: Fix fan wheel puller

→ Fix the fan wheel puller.

→ Continue to screw in the screw on the puller with the appropriate tool until the fan wheel comes off the shaft. Hold the fan wheel while doing so.

↳ Do not damage the fan wheel.

Remove shaft seal

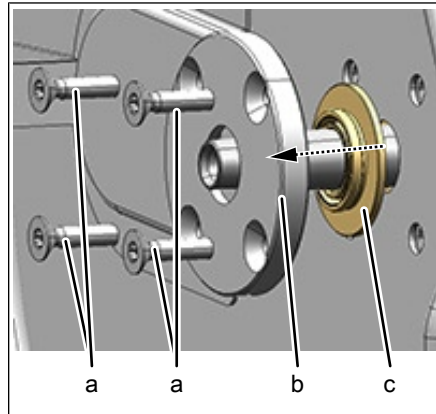

- a Screws Locking washer
- b Locking disc
- c Shaft seal fan motor

→ Remove the screws on the locking disc

→ Pull the locking disc off the motor shaft

→ Pull the shaft seal off the motor shaft

Install shaft seal

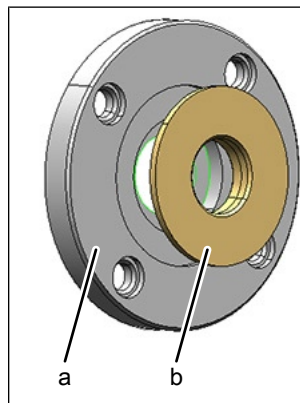

- a Locking disc
- b Shaft seal

→ Insert new shaft seal 10029110 into new locking washer 10028883. Observe the installation direction!

→ Grease the shaft seal with high-temperature grease.

→ Install locking washer with shaft seal.

INFORMATION

The torque should be 1.5 Nm.

Assemble remaining components

The remaining parts are assembled in the reverse order.