

Applies to conversion kit 10040099

INFORMATION

This operation panel requires software version 20xx.xx.xx and associated additional content

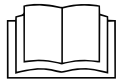

Read the installation instructions for the units and observe the safety information.

The target group for this installation manual is trained qualified personnel entrusted with the technical functioning and operation of the unit.

Safety instructions

Organizational measures

Risk of property damage and personal injury from lack of organizational measures

- Use equipment and protective gear suitable for the activity.

Danger of electric shock from live components.

- Prior to working on the electrical system, switch off the unit, disconnect the electrical system from the mains and prevent power from being switched on again. Check to ensure the system is dead.
- Use only insulated tools.

Scope of delivery

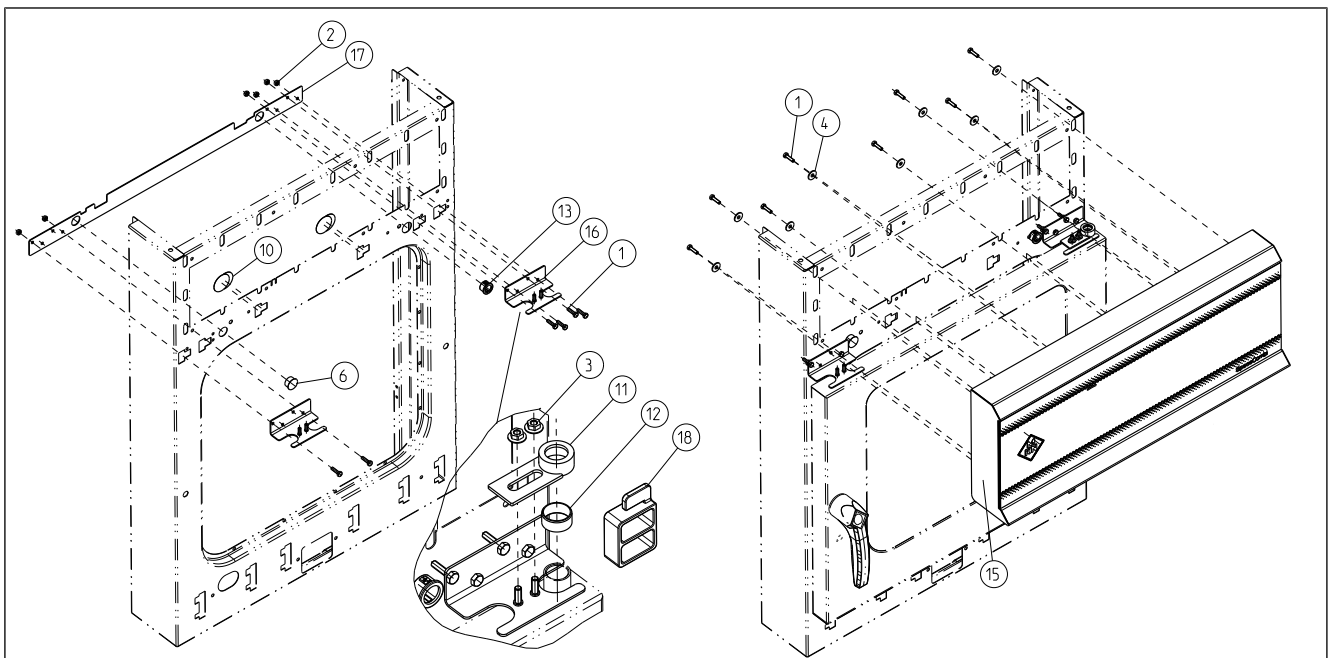

- 1 14 x hexagon head screw M4 x 16 mm
- 3 2 x M4 lock nut
- 6 1 x cover cap
- 11 1 x door hinge
- 13 1 x cable bushing
- 16 2 x door holder
- 18 1 x mounting aid for door

- 2 6 x M4 nut
- 4 8 x washer 5.3 mm
- 10 4 x stickers
- 12 1 x plain bearing
- 15 1 x operation panel
- 17 1 x reinforcement plate

Order of steps

- Backing up data if service menu can be accessed
- Exporting your own cooking programs to a USB stick (if available)
- Removing the operation panel
- Transferring the SD card to the new operation panel
- For version with WLAN: Transfer cables/ prepare operation panel
- Removing the cooking chamber door
- Install door holder with cooking chamber door
- Installing and connecting the operation panel
- Updating the software and importing additional content
- Setting the date and time
- Restoring data
- Importing your own cooking programs from a USB stick
- Load OEM settings and select cookbook

Preparing the USB stick

Prerequisite

- USB stick.
 - ↳ Formatting FAT (standard).
 - ↳ The disk should be empty if possible.
- Latest software update and additional content
 - ↳ The update is available on the manufacturer's website.

INFORMATION

The additional content contains sound files and graphics. These must be installed after replacing the operation panel.

Preparing the USB stick

- Open and unzip the downloaded zip file.
- Copy the unpacked folders "MMIUpdate", "Content_CODG2" and "Cooking_CODG2" into the main directory of the USB stick. The content and folder structure must not be changed.

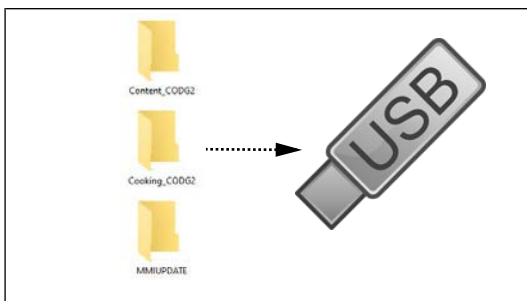

Opening the Settings menu and Service menu

Replacement requires access to the Settings menu, Basic settings and Service menu.

Calling up the Setting menu

- Switch on the unit.
- Tap the "Unit functions" button.
 - ↳ Display of *Appliance functions* menu.
- Tap the "Settings" field.
 - ↳ Display of *PIN* window.
- Enter password "111" and tap the *Confirm* field.
 - ↳ Display of Device Settings menu.

Opening the Service menu

- Switch on the unit.
- Tap the "Unit functions" button.
 - ↳ Display of *Appliance functions* menu.
- Tap the "Settings" field.
 - ↳ Display of *PIN* window.
- Enter password "1967" and tap the *Confirm* button.
 - ↳ Display of the Service menu.

Backing up data

Backup function for parameters (for example, customer settings, calibration values). Saving data on the internal SD card and USB stick (if plugged in).

1. Open the Service menu as described.
2. Tap the " Backup data" field.
3. Touch the *Confirmation* field.
 - ↳ Backup data on the SD card.
 - ↳ A confirmation then appears on the touchscreen.
4. Tap the "OK" field.

Exporting your own cooking programs



a buttonAutoChef

- Switch on the unit.
- Insert the USB flash drive.
- Tap the "autoChef" button.
 - ↳ Display of *Automatic cooking (autoChef)* menu.
- Tap the "autoChef" button in the information strip.
 - ↳ Display of *autoChef* window.
- Tap the "Export cooking programs" field.
- Tap the *Confirm* button.
 - ↳ All user-created cooking programs are exported to the USB stick from the cookbook.
 - ↳ A confirmation then appears on the touchscreen.

Opening the appliance

→ Remove the top cover from the unit.

For units with MagicHood, the hood must be removed beforehand.

→ Remove the left side wall.

→ Remove the right side panel.

Remove cables

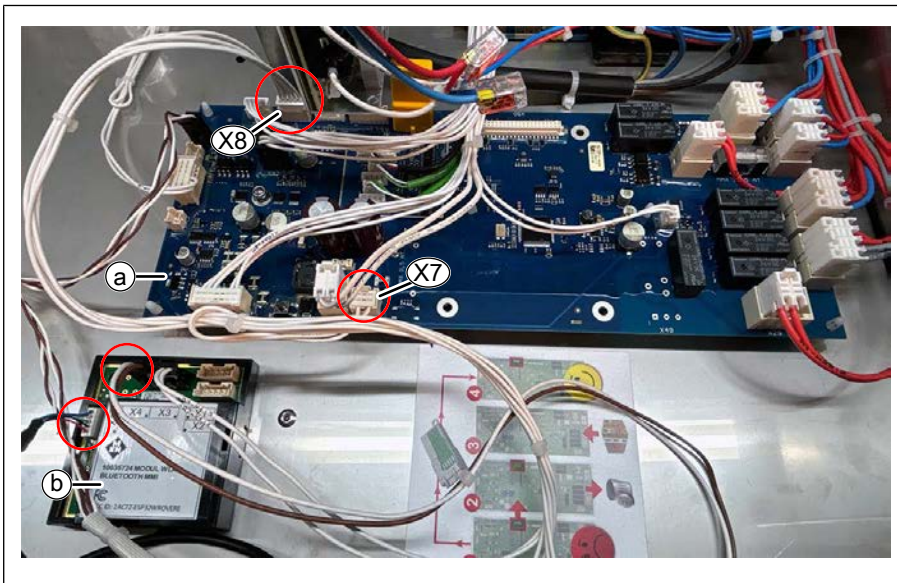

Image: Control board and WLAN module

- | | | | |
|----|---|----|---------------|
| a | WLAN module | b | Control board |
| X7 | Power supply control board/ WLAN module | X8 | CAN cable |

Version without WLAN module

→ Disconnect the supply cable from X7 and X8 on the control board.

→ Remove the protective conductor cable to the operation panel.

→ Remove cable ties if necessary.

Version with WLAN module

→ Disconnect the cable leading to the operation panel from the WLAN module.

Removing the operation panel



Image: Remove the operation panel screws

- Open the cooking chamber door
- Remove the four fixing screws. For the outer screw in the hinge area, open the cooking chamber door by about 30-60°, otherwise access will not be possible.
- Slide the operation panel upwards and remove it.

Prepare new operation panel

Overview

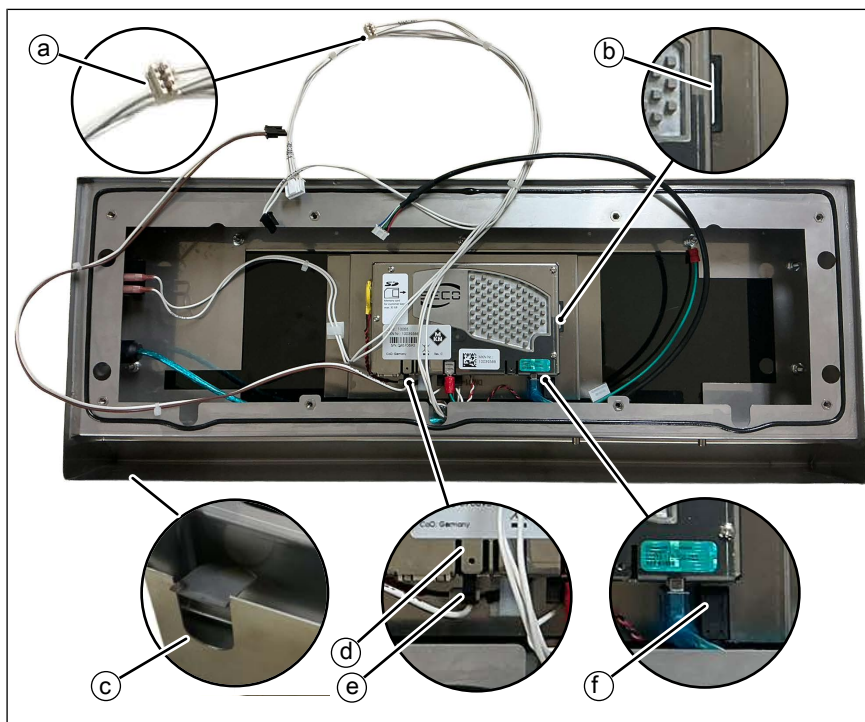

Image: Rear operation panel for mounting with WLAN module

- | | |
|--|-----------------------------------|
| a Plug from wiring harness 24V | b Slot for SD card |
| c Breakthrough for cooking chamber door. Here for version with right-hand stop | d Protective conductor connection |
| e 24V connection | f Micro USB connection |

Remove the opening for the cooking chamber door

- Remove the opening for the cooking chamber door. The opening to be removed depends on the door hinge.

Transfer SD card

- Remove the SD card from the new operation panel. The SD card is not required.
- Insert the SD card removed from the existing operation panel.

INFORMATION

The SD card must be removed from the dismantled operation panel. This includes the manufacturer's cookbook.

Transfer lines for WLAN module (optional)

For units with a WLAN module, additional steps are required according to the overview.

- Plug in the previously removed micro USB cable. The end is later plugged into the WLAN module.
- disconnect the 24V plug from the operation panel wiring harness. This is later plugged into the WLAN module. Remove cable ties if necessary.
- Plug in the previously removed 24V cable. The end is later plugged into the WLAN module.

Preparing to remove the cooking chamber door

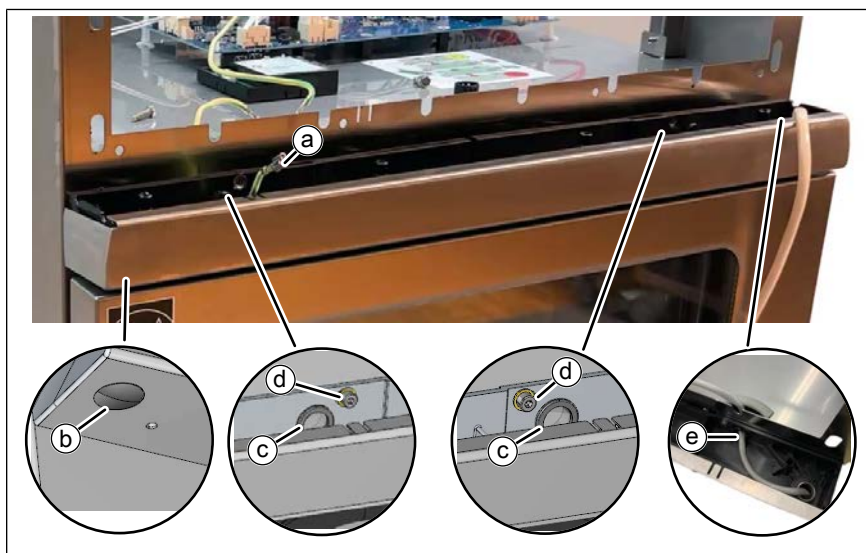

Image: Mounting door holder

- | | |
|-------------------------------|-----------------------|
| a Protective conductor | b Bottom dummy cap |
| c Cable entry insert | d M4 bolt with washer |
| e Cooking chamber light cable | |

- Open the cooking chamber door and remove the lower blind cap.
- Close the cooking chamber door. Disconnect the plug of the cooking chamber light supply cable from the control board. Then pull the cable out to the front. This must be exposed.
- Remove the protective conductor cable, cable glands and screws.

NOTICE

Material damage and personal injury due to falling cooking chamber door

Remove the screws with the cooking chamber door closed.

Removing the cooking chamber door

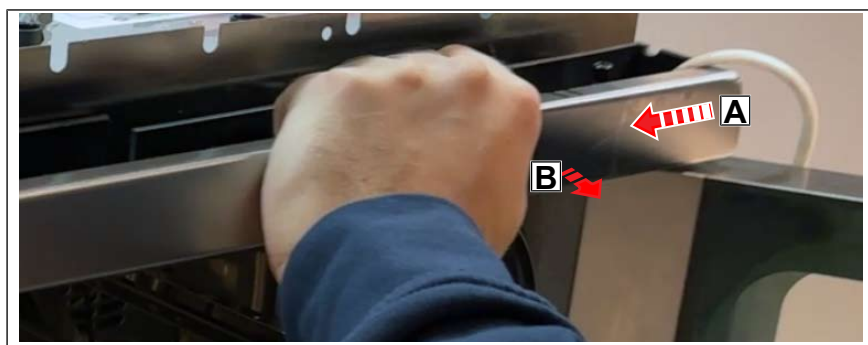

Image: Removing the cooking chamber door

- Carefully open the cooking chamber door and hold it firmly.
- Hold the door holder with your second hand.
- Carefully slide the door holder to the left.
 - ↳ Door holder with cooking chamber door is unhinged
- Remove the cooking chamber door with door holder.

Fitting the door holder

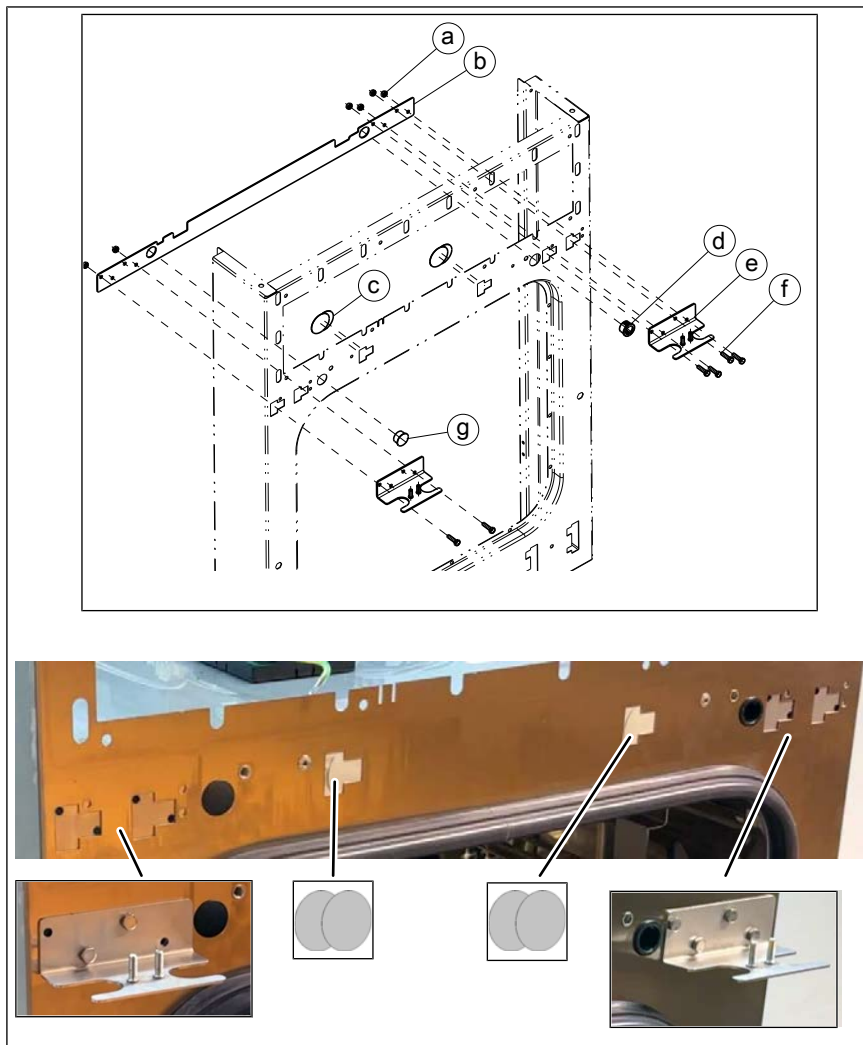

Image: Fitting the door bearing and reinforcement plate

- | | |
|------------------|----------------------|
| a Nut M4 | b Reinforcing plate |
| c 2 x 2 stickers | d Cable entry insert |
| e Door holder | f Screw, M4 x 16 |
| g Blind cap | |

- Cover the two middle openings of the front panel with the stickers. The stickers must be applied from the rear.
- Insert the reinforcement plate laterally behind the front panel. First fit the dummy cap and the cable gland insert. This fixes the reinforcement plate in place.
- Fit both door holders.

Fitting the cooking chamber door

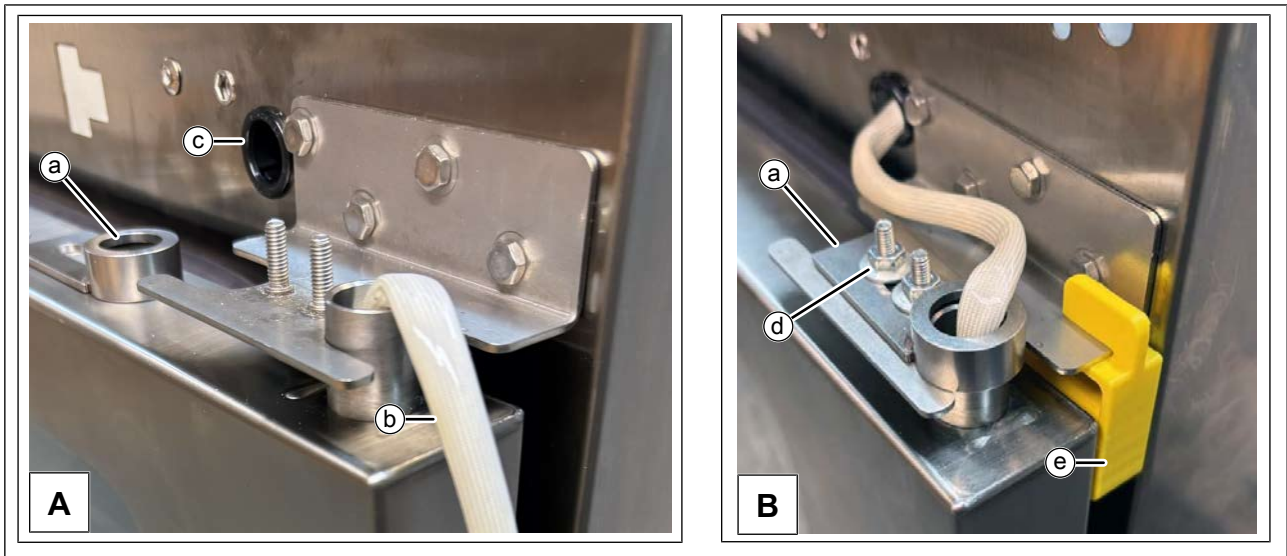
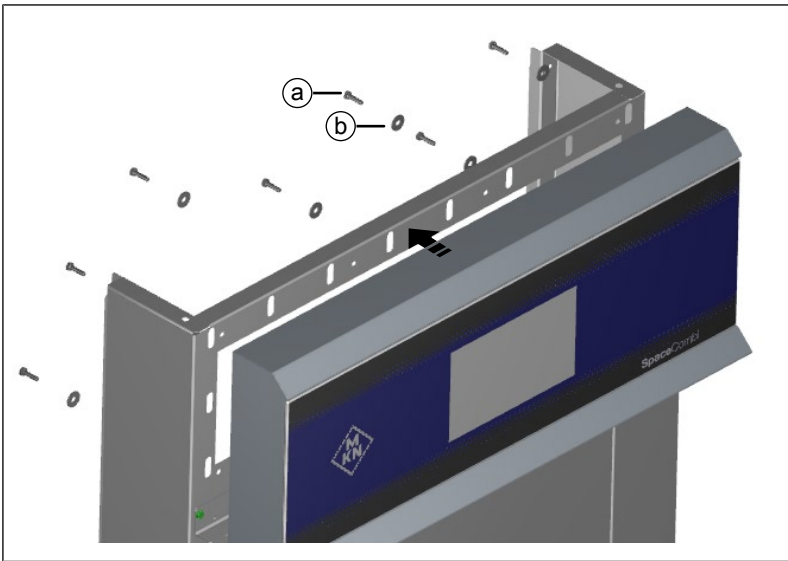

Image: A = Hang in door; B = Fit door hinge

- | | |
|-------------------------------|------------------------------|
| a Upper door hinge | b Door lighting supply cable |
| c Cable feed-through Lighting | d M4 door hinge nut |
| e Assembly aid | |

- Place the cooking chamber door on the lower door hinge.
- Insert the cooking chamber door into the upper door holder and close the door completely.
- Pull the cable through the upper door hinge
- Attach the door hinge to the door/door holder.
- Attach the enclosed mounting aid.
- Align the cooking chamber door Tighten the nuts. Remove mounting aid
- Guide the cable through the feed-through to the control board and plug it in.

Installing the operation panel



a M4 screw

b Washer

→ Mount the operation panel using the enclosed screws and washers.

Connecting the operation panel

Version without WLAN module

- Connect the supply cable to X7 and X8 on the control board.
- Connect the protective conductor cable to the operation panel.
- Secure the cables with cable ties.

Version with WLAN module

- Connect the supply cable to X7 and X8 on the control board.
- Connect the protective conductor cable to the operation panel
- Connect the cable coming from the operation panel to the WLAN module (24 V and micro USB).
- Connect the 24V cable coming from the control board to the WLAN module.

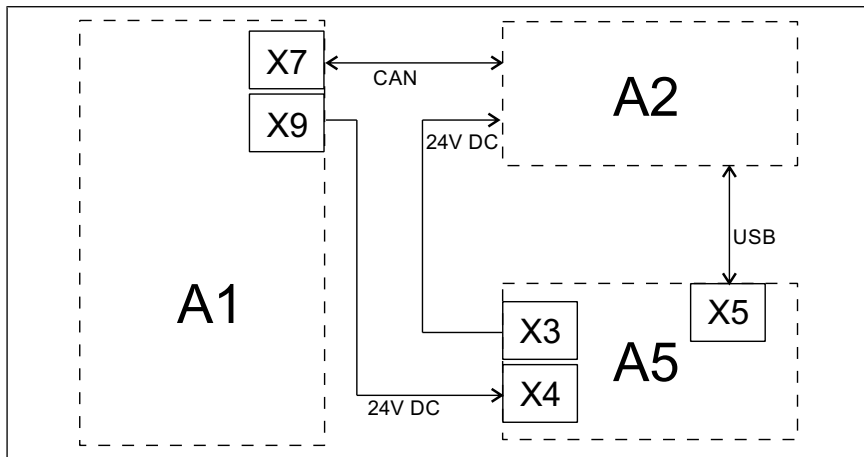

Image: Block diagram for version with WLAN

A1 Control board
A5 WLAN module

A2 Control operation panel

Line A1, X9 - A5, X4: 24 V white/white

Cable A2 - A5, X3: 24 V brown/white

Closing the unit

The conversion is complete.

- Carry out function check. After switching on, the cooking chamber light in the door lights up and the screen switches on.
- De-energize unit.
- Fit the side panels, appliance cover and supply air cover.
- Switch on the power and continue with the software update.

Updating the software

- Insert the USB stick
- Switch on the unit.
 - ↳ Follow the instructions on the touchscreen

INFORMATION

The update can take up to 15 minutes.

- ↳ A confirmation then appears on the touchscreen
- Tap the "OK" field
 - ↳ The software restarts automatically

INFORMATION

After the update, a blue screen may appear and the software does not start. In this case, switch the unit off and then back on. In rare cases, this may happen again.

Import additional content

- Insert the USB stick.
- Open the Service menu as described.
- Select the field "Import additional contents" on the left area of the menu by swiping.
- Tap the "Import additional contents" field.
- Tap the "OK" field.
 - ↳ The data is imported.
- A confirmation then appears on the touchscreen.
- Tap the "OK" field.

Restoring data

1. Open the Service menu as described.
2. Tap the "Restore data" field.
3. Touch the *Confirmation* field.
 - ↳ Restore data from the SD card.
 - ↳ A confirmation then appears on the touchscreen.
4. Tap the "OK" field.

Importing your own cooking programs

- Switch on the unit.
- Insert the USB flash drive.
- Tap the "autoChef" button.
 - ↳ Display of *Automatic cooking (autoChef)*. menu.
- Tap the "autoChef" button in the information strip.
 - ↳ Display of *autoChef*. window.
- Tap the "Import cooking programs" field.
- Tap the *Confirm* button.
 - ↳ All cooking programs on the USB stick are imported to the cookbook.
 - ↳ A confirmation then appears on the touchscreen.

Settings

Setting the date and time

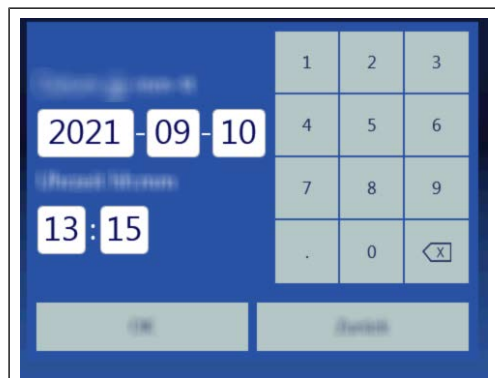

Prerequisite

- Open the Settings menu as described.
- Tap the "Set date and time" field.
 - ↳ The *Setting* window opens.
 - ↳ The *Keyboard* opens.
- Enter the date and time.
- Tap the Confirm button.
 - ↳ The *Keyboard* closes.
- ↳ The date and time are set.

OEM settings

Loading settings

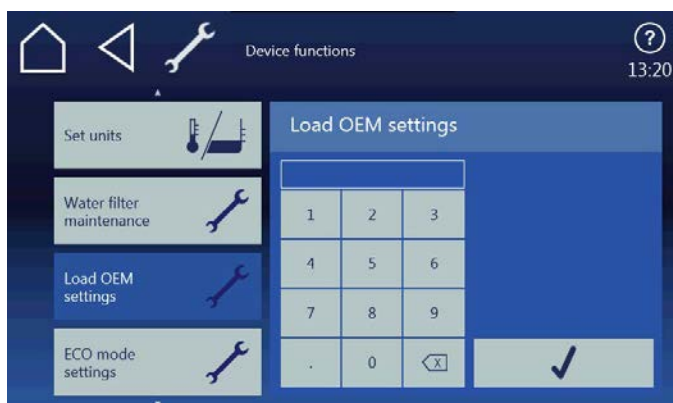

INFORMATION

The HennyPenny OEM code is 110000

- Open the Settings menu as described.
- Wipe to select the page with the "Load OEM settings" field in the left menu area.
- Tap the "Load OEM settings" field.
- Enter the OEM code and tap the *Confirm* field.
 - ↳ The data is loaded.
 - ↳ The software restarts automatically.

INFORMATION

A different OEM code may be required for some customer groups.

Select cookbook

INFORMATION

After the OEM settings have been loaded, select the cookbook.



- Open the Settings menu as described.
- tap on "Select cookbook".
- Select cookbook and confirm with OK.
- Restart the device using the button *On Off*.